

The Universal Cube

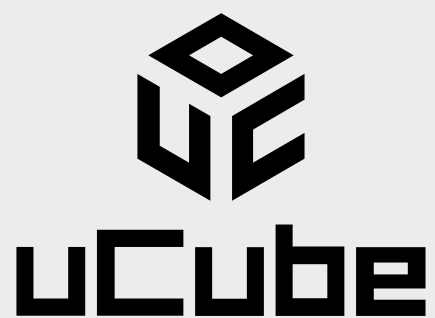

www.ucube.swiss

AEREM[®]
TO FILTER & PROTECT

Produced by Aerem
www.aerem.com



Summary

1	History	4
2	Technology	5
3	Why choose uCube?	6-7
4	Products	8-9
5	Installation	10-13

History

Ucube was developed by the AEREM team, using the technology of inertial separation. From the beginning of the development, we wanted to use the best of the existing and recyclable raw materials, namely cardboard and polyester.

The mix of these materials gave the best load capacity and filtration, after two years of development and a hundred test, the universal cube was born in early 2019.

All this research and these many reflections make uCube an easy product to assemble, which allows the reduction of the costs and the optimization of the transport.



Technology

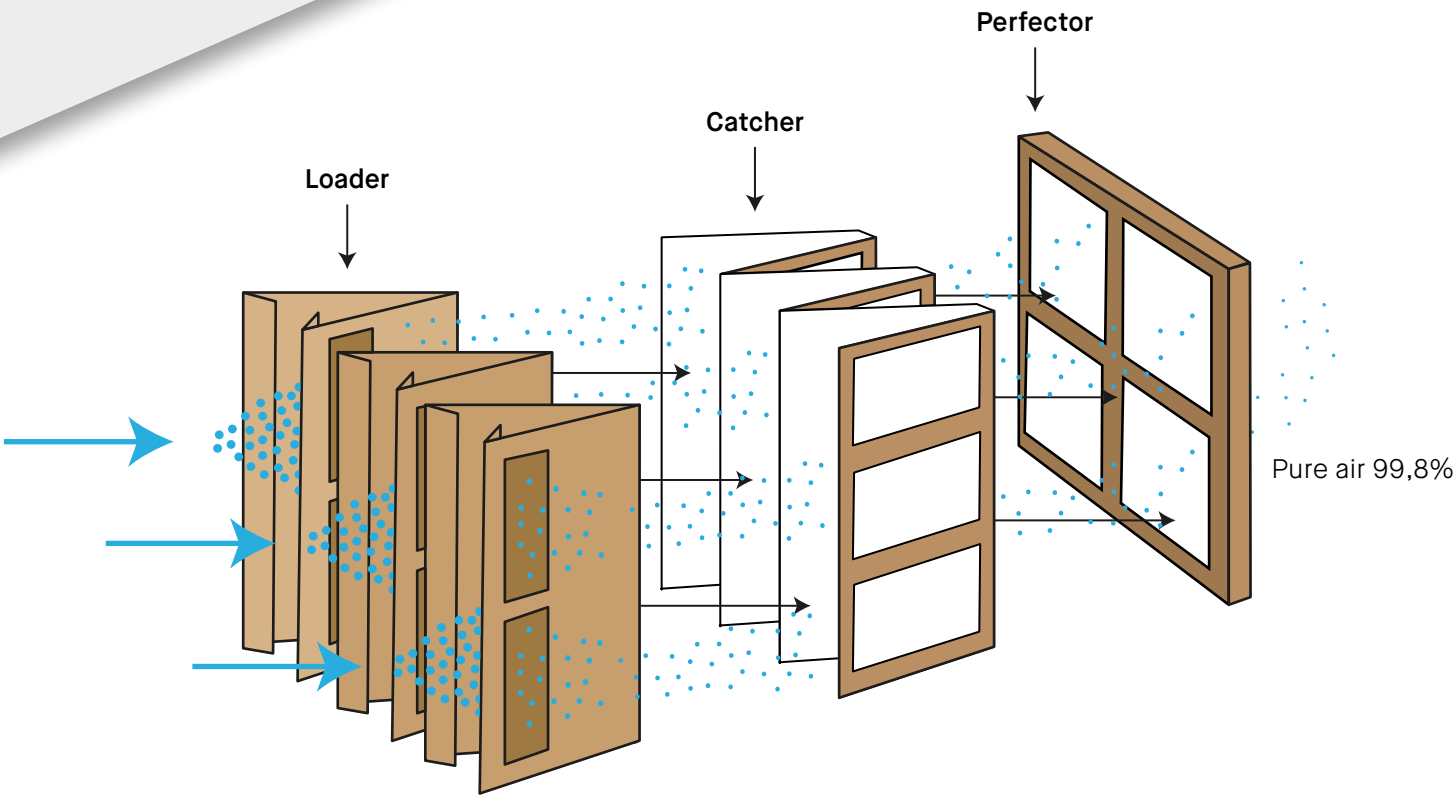

Our Technology

- Loader:**
At first, the Loader will filter 74% of the paint.
- Catcher:**
Then, the Catcher will stop 24% of the extra paint thanks to its polyester filter.
- Perfector:**
And finally, the Perfector will sharp the last particles to have a 99,8% pure air.

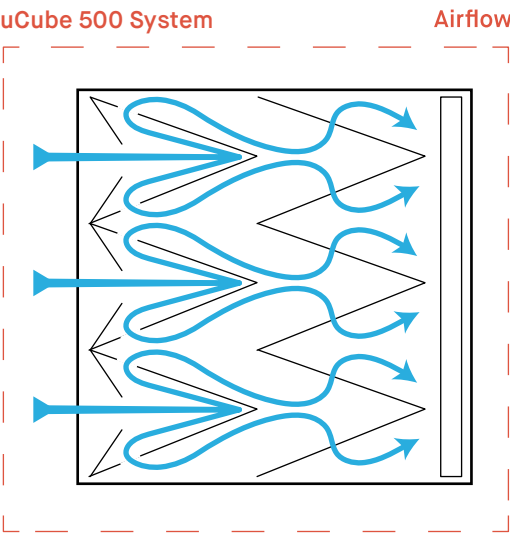

Why choose uCube ?

- ✓ Cost Savings
- ✓ Over 30kg of Loading Charge
- ✓ Efficacy Up To 99,45%
- ✓ Longer Filter Life
- ✓ Low Airflow Resistance
- ✓ Quick Installation
- ✓ Easy Transport

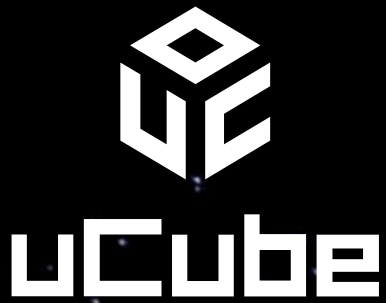

✓ Charge: Over 30kg

✓ Efficiency: 99,45%

Competitor cube



Charge until 25kg
Efficiency: 97%



Charge until 20-25kg
Efficiency: 80-95%



Charge until 6kg
Efficiency: 99%





300

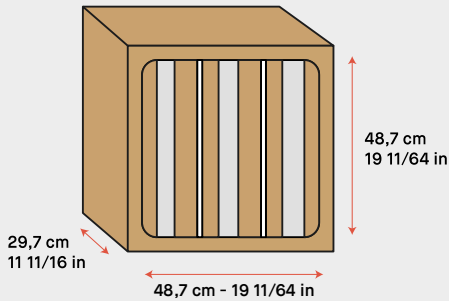

Dimensions

Lenght	Height	Width
48,7 cm 19 11/64 in	48,7 cm 19 11/64 in	29,7 cm 11 16/16 in

Empty: 1399g

Recommended Air Velocity: 0,50 to 2,00

Initial Pressure Drop: 20 to 130 dependant on the air velocity

Max Pressure Drop: 800 pa.



500

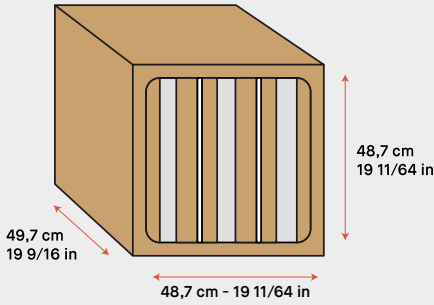

Dimensions

Lenght	Height	Width
48,7 cm 19 11/64 in	48,7 cm 19 11/64 in	49,7 cm 19 9/16 in

Empty: 2247g

Recommended Air Velocity: 0,50 to 2,00

Initial Pressure Drop: 20 to 130 dependant on the air velocity

Max Pressure Drop: 800 pa.

Installation Guide - 300

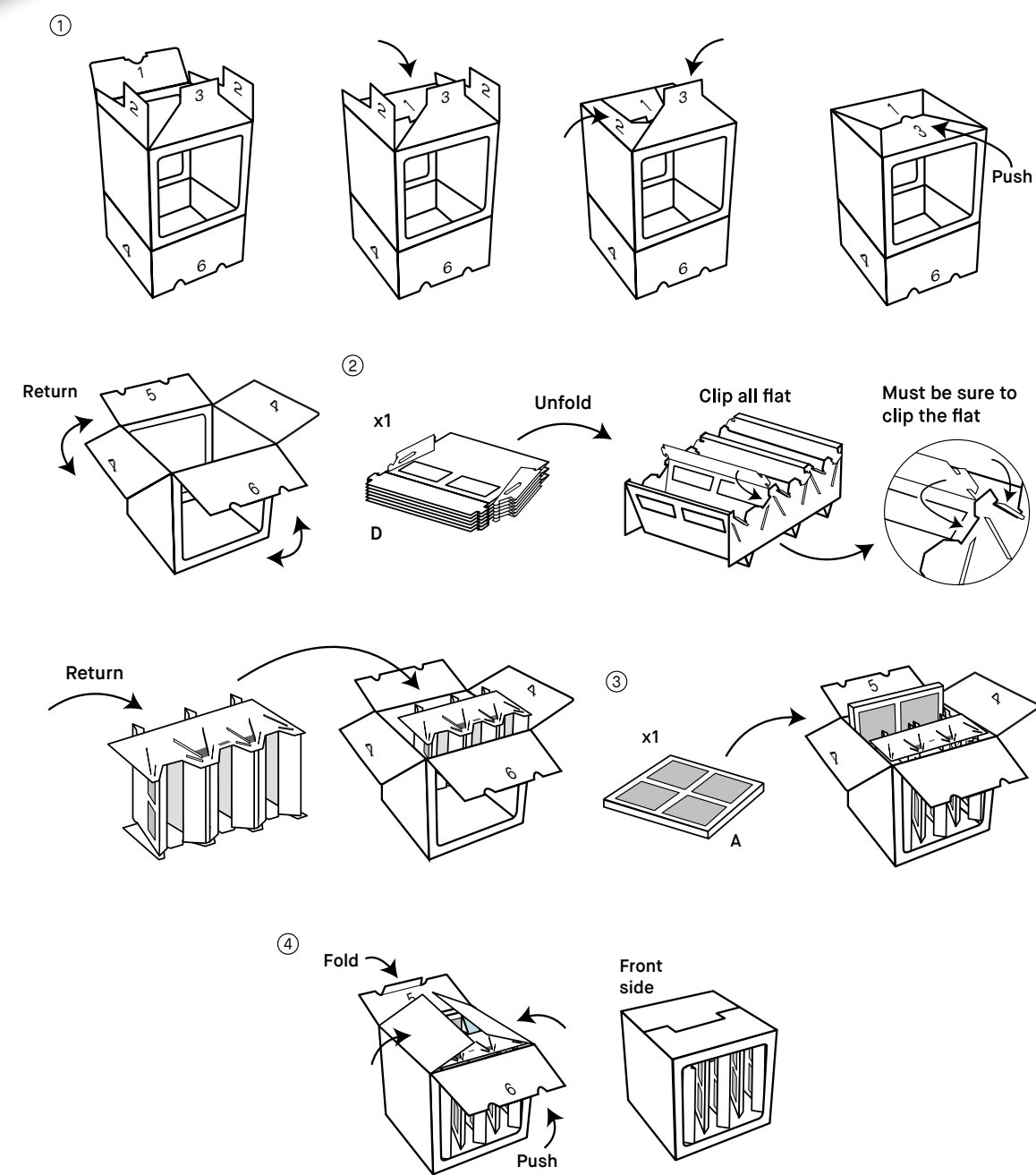

The set-up videos are available here:
www.ucube.swiss
 Aerem Youtube Channel

Installation Guide - 500

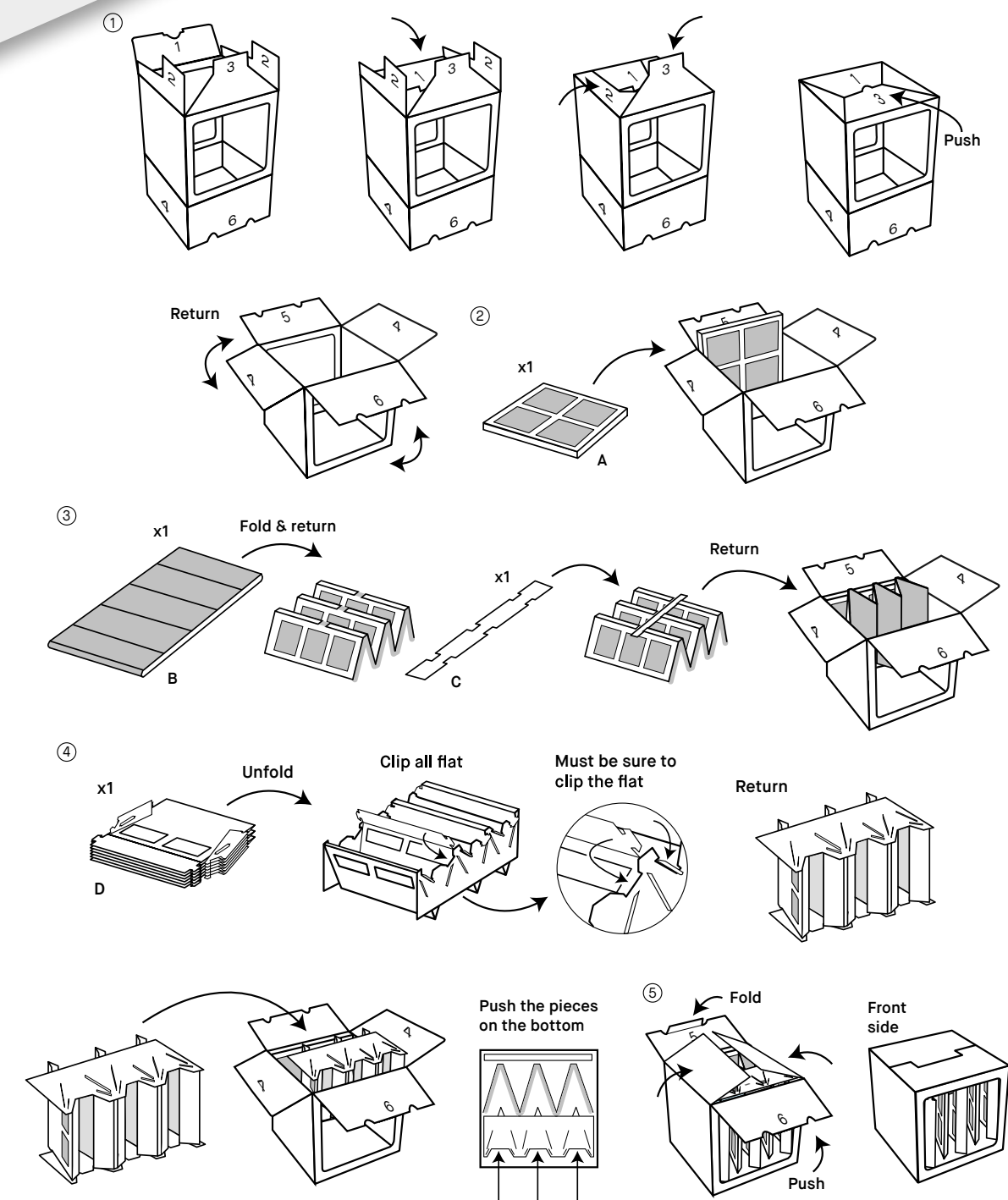

The set-up videos are available here:
www.ucube.swiss
 Aerem Youtube Channel

uCube Installation

Materials Required

- Tack cloth,
- Scissors, knife or box cutter,
- Industrial tape

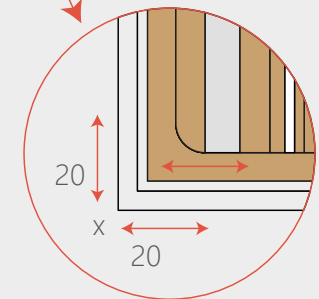
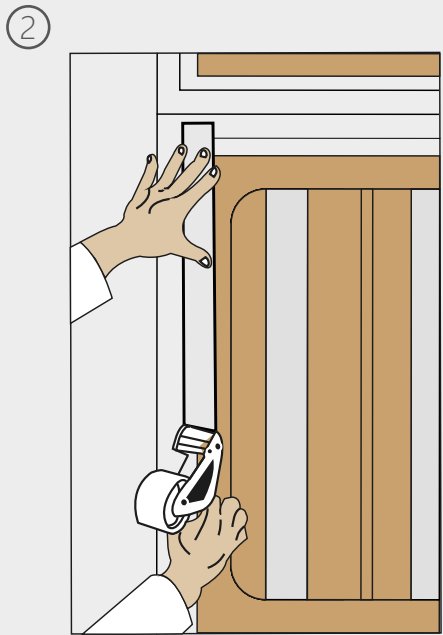
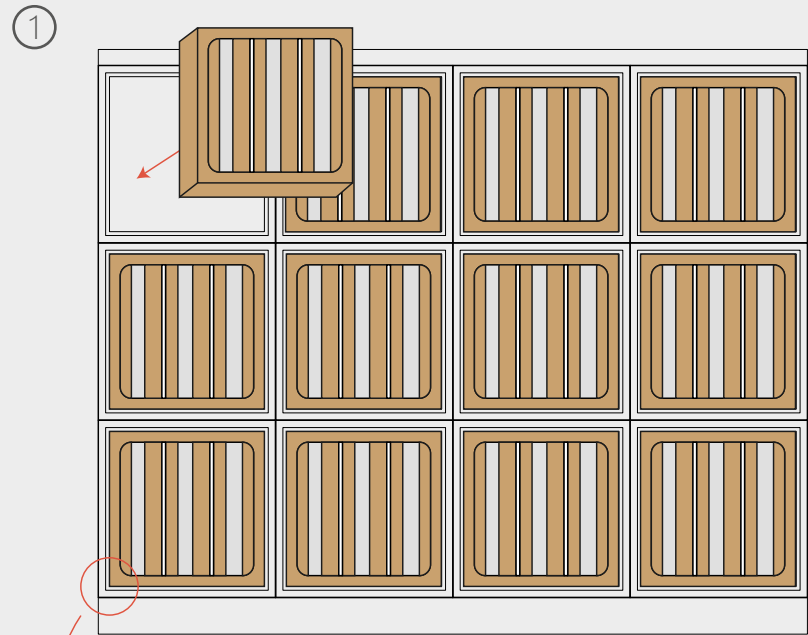

Spraying Room



A full cabin
For all spray booths



AEREM[®]

TO FILTER & PROTECT

OUR MISSION

AEREM focuses on its customers and partners needs in the finishing industry. Every relationship is a privileged partnership based on professionalism, dialog and trust. Delivering the best service with performant, environmentally friendly quality products easy to dispose of is our commitment since 1963.

Our mission is to develop, manufacture and supply high performant filtration and protection products for spray booths that aim to keep a clean and safe working environment while enhancing the spray booths productivity.

OUR VISION

AEREMs ambition is to affirm its position by becoming an international multi-brand company focused on the global finishing industry with a wide variety of renowned and innovative filtration and protection products.

OUR VALUES

AEREM is above all a work of men and women united around the world for the success of the Group.
They all share the same values in a solidarity and caring climate.



ENVIRONMENT

Protecting the environment is the responsibility of everyone. AEREM uses recycled raw materials in all of its products. Our sharply tuned and performant production processes results in low waste and low energy consumption.



CUSTOMER CARE

Because all our customers are important, our priority is to support them in their projects, build and maintain a long-term partnership to be able to bring the answers adapted to each need. Over 900 distributors around the world trust us.



PROTECTION

We seriously consider the need to protect the operator and provide a secure working environment through our products and services. This is why our filters are free of polluting or toxic products. They can be stored, handled and incinerated or landfilled safely.



MULTICULTURALISM

Aerem is a selfie of multiculturalism and diversity. Our teams are made of men and women of different languages, cultures and origins. It is in this spirit of openness and diversity that we seek to build a partnership with you.



RESPECT & INTEGRITY

We treat others with respect and comply with all internal and external norms and regulations. We strive to always act with transparency and honesty.



AEREM LOCATIONS WORLDWIDE



AMERICAS



CANADA

5000 Rue Hickmore
Saint-Laurent, QC H4T 1K6
Tel: +1 514-375-7100
Customers.ame@aerem.com



USA

422 2nd Ave NW
Ardmore, OK 73401
Tel: +1 866 263 7323
Customers.ame@aerem.com

EUROPE



SWITZERLAND

Rue du Jeu de L'Arc 15
CH - 1207 Genève
Tel: +41 21 869 93 63
Customers.eur@aerem.com



POLAND

ul. Lubczyńska 6 F
PL - 70-895 Szczecin
Tel: +48 91 884 90 00
Customers.eur@aerem.com

ASIA-PACIFIC



SINGAPORE

22 Gemmill Lane #03-01
Singapore 069257
Tel : +65 6922 7800
Customers.api@aerem.com



HONG-KONG

20th Floor, Euro Trade Center
21-23 Des Voeux Road Central
Tel: +852 2824 8156
Customers.api@aerem.com

AEREM[®]
TO FILTER & PROTECT

www.aerem.com

Follow us on

